

NOTICE!!

These documents have been scanned!

Do not place un-scanned documents beneath this notice!

Do not remove this notice from this file!

GPO Jacket No. 560-102
Print Order 61540
Rise Business Services, LLC
Job=AZ15 5/6/2019



Box Number= AZ15020



Claim Begin-End: AMC435950-AMC435955

1 Initial Receipt



AZ15020-4

AMC435945-AMC436659

United States Department of the Interior
Bureau of Land Management
 LANDS/RECREATION & PLANNING
 ONE N CENTRAL AVE
 PHOENIX, AZ 85004 -2203
 Phone: 602-417-9200

Receipt

No: 3472855

Transaction #: 3572877	
Date of Transaction: 01/12/2016	
CUSTOMER:	
NAU PROJECT LLC 807 BUTTERFIELD RD CHINO VALLEY, AZ 86323-5622 US	

ENTERED
 JAN 15 2016
 BY *jr*

LINE #	QTY	DESCRIPTION	REMARKS	UNIT PRICE	TOTAL
1	6.00	LOCATABLE MINERALS / MINING CLAIMS-NEW, UNADJUD, ONE OR MORE AUTH NOS / NEW MINING CLAIM PROCESSING FEE CASES: AMC435950/\$20.00, AMC435951/\$20.00, AMC435952/\$20.00, AMC435953/\$20.00, AMC435954/\$20.00, AMC435955/\$20.00		- n/a -	120.00
2	6.00	LOCATABLE MINERALS / MINING CLAIMS-NEW, UNADJUD, ONE OR MORE AUTH NOS / NEW MINING CLAIMS LOCATION FEE CASES: AMC435950/\$37.00, AMC435951/\$37.00, AMC435952/\$37.00, AMC435953/\$37.00, AMC435954/\$37.00, AMC435955/\$37.00		- n/a -	222.00
3	6.00	LOCATABLE MINERALS / MINING CLAIMS-NEW, UNADJUD, ONE OR MORE AUTH NOS / NEW MINING CLAIMS MAINTENANCE FEE CASES: AMC435950/\$155.00, AMC435951/\$155.00, AMC435952/\$155.00, AMC435953/\$155.00, AMC435954/\$155.00, AMC435955/\$155.00		- n/a -	930.00
TOTAL:					\$1,272.00

PAYMENT INFORMATION				
NOTE: Items will appear on credit card statement as "Bureau of Land Mgmt CO".				
1	AMOUNT:	1272.00	POSTMARKED:	N/A
	TYPE:	CREDIT CARD	RECEIVED:	01/12/2016
	NAME:	NAU PROJECT LLC 807 BUTTERFIELD RD CHINO VALLEY AZ 86323-5622 US		
	CARD NO:	XXXXXXXXXXXX1925	AUTH CODE:	01283Z

NAME ON CARD:	GREGORY YOUNT
EXPIRES:	01/2018
SIGNATURE:	

REMARKS

This receipt was generated by the automated BLM Collections and Billing System and is a paper representation of a portion of the official electronic record contained therein.

NOTICE!!

These documents have been scanned!

Do not place un-scanned documents beneath this notice!

Do not remove this notice from this file!

GPO Jacket No. 560-102
Print Order 61540
Rise Business Services, LLC
Job=AZ15 5/6/2019



Box Number= AZ15020



Claim Begin-End: AMC435950-AMC435955

2 Correspondence



AZ15020-4

AMC435945-AMC436659

SENDER: COMPLETE THIS SECTION

- Complete items 1, 2, and 3.
- Print your name and address on the reverse so that we can return the card to you.
- Attach this card to the back of the mailpiece, or on the front if space permits.

NAU PROJECT LLC
 807 W BUTTERFIELD RD
 CHINO VALLEY AZ 86323-5622
 920/RE/AMC435950



9590 9402 1568 5362 4562 78

*2. Article Number (Transfer from service label)

7016 0340 0000 0063 5061

COMPLETE THIS SECTION ON DELIVERY

A. Signature
 X *Deanna Steeler* Agent Addressee

B. Received by (Printed Name) C. Date of Delivery
 _____ 9/27

D. Is delivery address different from item 1? Yes
 If YES, enter delivery address below: No

3. Service Type

<input type="checkbox"/> Adult Signature	<input type="checkbox"/> Priority Mail Express®
<input type="checkbox"/> Adult Signature Restricted Delivery	<input type="checkbox"/> Registered Mail™
<input checked="" type="checkbox"/> Certified Mail®	<input type="checkbox"/> Registered Mail Restricted Delivery
<input type="checkbox"/> Certified Mail Restricted Delivery	<input checked="" type="checkbox"/> Return Receipt for Merchandise
<input type="checkbox"/> Collect on Delivery	<input checked="" type="checkbox"/> Signature Confirmation™
<input type="checkbox"/> Collect on Delivery Restricted Delivery	<input type="checkbox"/> Signature Confirmation Restricted Delivery
<input type="checkbox"/> Insured Mail	
<input type="checkbox"/> Insured Mail Restricted Delivery (D)	

USPS TRACKING #



First-Class Mail
Postage & Fees Paid
USPS
Permit No. G-10

9590 9402 1568 5362 4562 78

United States
Postal Service

• Sender, please print your name, address, and ZIP+4® in this box •

RECEIVED
BLM AZ STATE OFFICE

2016 SEP 22 P 2:58

PHOENIX, ARIZONA

UNITED STATES
DEPARTMENT OF THE INTERIOR
Bureau of Land Management
Arizona State Office
One N. Central Avenue, Suite 800
Phoenix, AZ 85004-4427



United States Department of the Interior

BUREAU OF LAND MANAGEMENT

Arizona State Office

One North Central Avenue, Suite 800

Phoenix, Arizona 85004-4427

www.blm.gov/az/

SEP 16 2016



In Reply Refer To:

3800 (9200) RE

AMC435950

CERTIFIED MAIL - RETURN RECEIPT REQUESTED No. 7016 0340 0000 0063 5061

DECISION

NAU PROJECT LLC : This decision affects those claims shown
807 W BUTTERFIELD RD : in the block below.
CHINO VALLEY, AZ 86323-5622 :

AMC435955
TWIN EAGLE #4

DECISION VACATED

The decision of September 7, 2016, is hereby vacated.

Upon further investigation, our records show receipt of all required documents on or before the due date. Our records have been updated to show the claims in a current status.

Please include your AMC serial number(s) on all correspondence. If additional information is required, contact Rod Ebert at 602-417-9397.

for Amy F. Thoma
Rebecca Heick
Deputy State Director
Lands, Minerals and Energy Division

SENDER: COMPLETE THIS SECTION

- Complete items 1, 2, and 3.
- Print your name and address on the reverse so that we can return the card to you.
- Attach this card to the back of the mailpiece, or on the front if space permits.

1. Article Addressed to:

NAU PROJECT LLC
807 W BUTTERFIELD RD
CHINO VALLEY AZ 86323-5622
920/RE/AMC435950

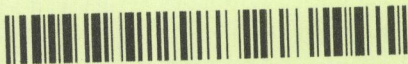

9590 9402 2006 6123 3773 60

2. Article Number (Transfer from service label)

7015 1660 0000 0271 8693

COMPLETE THIS SECTION ON DELIVERY

A. Signature

X *Tracy Strickland* Agent Addressee

B. Received by (Printed Name)

C. Date of Delivery

8/12

D. Is delivery address different from item 1? Yes
If YES, enter delivery address below: No

3. Service Type

- Adult Signature
- Adult Signature Restricted Delivery
- Certified Mail®
- Certified Mail Restricted Delivery
- Collect on Delivery
- Collect on Delivery Restricted Delivery
- Insured Mail
- Insured Mail Restricted Delivery
- Priority Mail Express®
- Registered Mail™
- Registered Mail Restricted Delivery
- Return Receipt for Merchandise
- Signature Confirmation™
- Signature Confirmation Restricted Delivery

USPS TRACKING#

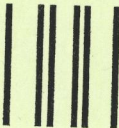

First-Class Mail
Postage & Fees Paid
USPS
Permit No. G-10

9590 9402 2006 6123 3773 60

United States
Postal Service

• Sender: Please print your name, address, and ZIP+4® in this box•

UNITED STATES
DEPARTMENT OF THE INTERIOR
Bureau of Land Management
Arizona State Office
One N. Central Avenue, Suite 800
Phoenix, AZ 85004-4427

PHOENIX ARIZONA

2016 SEP 1 2 PM 03

RECEIVED
BLM/AZ STATE OFFICE

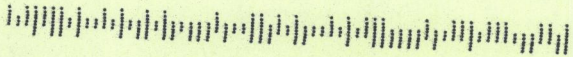



United States Department of the Interior



BUREAU OF LAND MANAGEMENT
Arizona State Office
One North Central Avenue, Suite 800
Phoenix, Arizona 85004-4427
www.blm.gov/az/

SEP 07 2016

In Reply Refer To:
3800 (9200) RE
AMC435950

CERTIFIED MAIL – RETURN RECEIPT REQUESTED NO. 7015 1660 0000 0271 8693

DECISION

NAU PROJECT LLC	:	This Notice Affects Those Claims
807 W BUTTERFIELD RD	:	Shown in the Block Below.
CHINO VALLEY, AZ 86323-5622	:	

Decision will be vacated

AMC435955
TWIN EAGLE #4

Mining Claims Declared Forfeit
Required Amendment Not Filed

*Decision sent in error.
Amendment 2 processing
fee were rec'd timely.
(thought processing fee rec'd
late.)*

In accordance with 43 CFR 3830.94, the mining claim listed above is hereby declared forfeit for the reason indicated below.

You received a Notice requiring that the mining claims (AMC435950 – AMC435955) filed in this office on January 11, 2016, be amended. The amendments were required to be filed within 30 days of the date you received the Notice. This office did receive amendments for AMC435950 and AMC435953 through AMC435955. Processing fees are \$10 per amendment. This office received \$30 with the amendments on June 30, 2016, the last day for the amended location notices and processing fees to be received timely. The 30 day timeframe allowed expired and the amendments were processed in numerical sequence. Therefore, there were insufficient fees to process the amendment for this claim and it is declared forfeit.

RE

This decision does not relieve you of the liability for reclamation of all areas disturbed by your activities on land encompassed by your mining claim(s) and/or site(s). After you complete the reclamation, you must notify the authorized officer of the appropriate surface managing agency so that the authorized officer may conduct a final site inspection and determine whether you may be released from liability. If you fail to reclaim the land to the satisfaction of the authorized officer, the surface management agency may cite you for noncompliance under its surface management regulations.

For land administered by the Bureau of Land Management (BLM), if you fail to reclaim the land to the satisfaction of the authorized officer as required in 43 CFR Subpart 3809, the BLM will issue an order of noncompliance under 43 CFR 3809.601(a). If you fail to comply with the noncompliance order, the BLM may take further action under 43 CFR 3809.604. Failure to conduct reclamation is a prohibited act that may subject you to criminal penalties. See 43 CFR 3809.605(h) and 43 CFR 3809.700. If your occupancy has been terminated and you fail to remove structures, material, and equipment, and any personal property in accordance with the regulations in 43 CFR 3715.5-1, the BLM may dispose of the property. In accordance with 43 CFR 3715.5-2, you will remain liable for the costs the BLM incurs in removing and disposing of the property.

Appeal Procedures

This decision may be appealed to the Interior Board of Land Appeals, Office of the Secretary, in accordance with the regulations contained in 43 CFR, Part 4 and the enclosed Form 1842-1. If an appeal is taken, your notice of appeal must be filed in this office (at the above address) within 30 days from receipt of this decision. The appellant has the burden of showing that the decision appealed from is in error.

If you wish to file a petition pursuant to regulation 43 CFR 4.21 (58 FR 4939, January 19, 1993), for a stay of the effectiveness of this decision during the time that your appeal is being reviewed by the Board, the petition for a stay must accompany your notice of appeal. A petition for a stay is required to show sufficient justification based on the standards listed below. Copies of the notice of appeal and petition for a stay must also be submitted to each party named in this decision and to the Interior Board of Land Appeals and to the appropriate Office of the Solicitor (see 43 CFR 4.413) at the same time the original documents are filed with this office. If you request a stay, you have the burden of proof to demonstrate that a stay should be granted.

Standards for Obtaining a Stay

Except as otherwise provided by law or other pertinent regulation, a petition for a stay of a decision pending appeal shall show sufficient justification based on the following standards:

- (1) The relative harm to the parties if the stay is granted or denied,
- (2) The likelihood of the appellant's success on the merits,
- (3) The likelihood of immediate and irreparable harm if the stay is not granted, and
- (4) Whether the public interest favors granting the stay.

If additional information is required, please contact Rod Ebert at 602-417-9397. Please include your AMC serial number(s) on all correspondence.

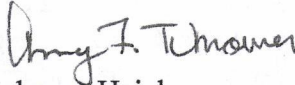
for Rebecca Heick
Deputy State Director
Lands, Minerals and Energy Division

Enclosure

SENDER: COMPLETE THIS SECTION

- Complete items 1, 2, and 3.
- Print your name and address on the reverse so that we can return the card to you.
- Attach this card to the back of the mailpiece, or on the front if space permits.

1. Article Addressed to:

NAU PROJECT, LLC
807 W BUTTERFIELD RD
CHINO VALLEY AZ 86323-5622
920/RE/AMC435950



9590 9402 1831 6104 4741 95

2. Article Number (Transfer from service label)

7015 1660 0000 0271 8174

COMPLETE THIS SECTION ON DELIVERY

A. Signature

X

B. Received by (Printed Name)

Agent

Addressee

C. Date of Delivery

D. Is delivery address different from item 1? Yes
If YES, enter delivery address below: No

3. Service Type

- Adult Signature
- Adult Signature Restricted Delivery
- Certified Mail®
- Certified Mail Restricted Delivery
- Collect on Delivery
- Collect on Delivery Restricted Delivery
- Insured Mail

- Priority Mail Express®
- Registered Mail™
- Registered Mail Restricted Delivery
- Return Receipt for Merchandise
- Signature Confirmation™
- Signature Confirmation Restricted Delivery

Mail Restricted Delivery (0)

USPS TRACKING#

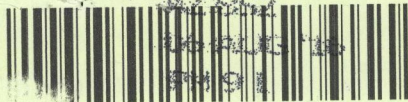

First-Class Mail
Postage & Fees Paid
USPS
Permit No. G-10

9590 9402 1831 6104 4741 95

United States
Postal Service

RECEIVED
BLM AZ STATE OFFICE

2016 AUG -9 A 8:00

PHOENIX, ARIZONA

• Sender: Please print your name, address, and ZIP+4® in this box •

UNITED STATES
DEPARTMENT OF THE INTERIOR
Bureau of Land Management
Arizona State Office
1000 N. Central Avenue, Suite 800
Phoenix, AZ 85004-4427

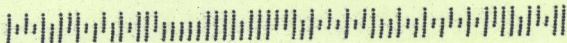



United States Department of the Interior



BUREAU OF LAND MANAGEMENT

Arizona State Office

One North Central Avenue, Suite 800

Phoenix, Arizona 85004-4427

www.blm.gov/az/

AUG 03 2016

In Reply Refer To:

3800 (9200) RE

AMC435950

CERTIFIED MAIL – RETURN RECEIPT REQUESTED NO. 7015 1660 0000 0271 8174

DECISION

NAU PROJECT, LLC	:	This Notice Affects Those Claims
807 W BUTTERFIELD RD	:	Shown in the Block Below.
CHINO VALLEY, AZ 86323-5622	:	

AMC435951 AMC435952
BRESCIA #4 - BRESCIA #5

Mining Claims Declared Forfeited Required Amendment Not Filed

In accordance with 43 CFR 3830.94, the mining claims listed above are hereby declared forfeited for the reason indicated below.

You received a Notice requiring that the claims listed above be amended. The amendment(s) were required to be filed within 30 days of the date you received the Notice. The 30 day timeframe allowed has expired and no amendment(s) have been received.

This decision does not relieve you of the liability for reclamation of all areas disturbed by your activities on land encompassed by your mining claim(s) and/or site(s). After you complete the reclamation, you must notify the authorized officer of the appropriate surface managing agency so that the authorized officer may conduct a final site inspection and determine whether you may be released from liability. If you fail to reclaim the land to the satisfaction of the authorized officer, the surface management agency may cite you for noncompliance under its surface management regulations.

For land administered by the Bureau of Land Management (BLM), if you fail to reclaim the land to the satisfaction of the authorized officer as required in 43 CFR Subpart 3809, the BLM will issue an order of noncompliance under 43 CFR 3809.601(a). If you fail to comply with the noncompliance order, the BLM may take further action under 43 CFR 3809.604. Failure to conduct reclamation is a prohibited act that may subject you to criminal penalties. See 43 CFR 3809.605(h) and 43 CFR 3809.700. If your occupancy has been terminated and you fail

to remove structures, material, and equipment, and any personal property in accordance with the regulations in 43 CFR 3715.5-1, the BLM may dispose of the property. In accordance with 43 CFR 3715.5-2, you will remain liable for the costs the BLM incurs in removing and disposing of the property.

Appeal Procedures

This decision may be appealed to the Interior Board of Land Appeals, Office of the Secretary, in accordance with the regulations contained in 43 CFR, Part 4 and the enclosed Form 1842-1. If an appeal is taken, your notice of appeal must be filed in this office (at the above address) within 30 days from receipt of this decision. The appellant has the burden of showing that the decision appealed from is in error.

If you wish to file a petition pursuant to regulation 43 CFR 4.21 (58 FR 4939, January 19, 1993), for a stay of the effectiveness of this decision during the time that your appeal is being reviewed by the Board, the petition for a stay must accompany your notice of appeal. A petition for a stay is required to show sufficient justification based on the standards listed below. Copies of the notice of appeal and petition for a stay must also be submitted to each party named in this decision and to the Interior Board of Land Appeals and to the appropriate Office of the Solicitor (see 43 CFR 4.413) at the same time the original documents are filed with this office. If you request a stay, you have the burden of proof to demonstrate that a stay should be granted.

Standards for Obtaining a Stay

Except as otherwise provided by law or other pertinent regulation, a petition for a stay of a decision pending appeal shall show sufficient justification based on the following standards:

- (1) The relative harm to the parties if the stay is granted or denied,
- (2) The likelihood of the appellant's success on the merits,
- (3) The likelihood of immediate and irreparable harm if the stay is not granted, and
- (4) Whether the public interest favors granting the stay.

If additional information is required, please contact Rod Ebert at 602-417-9397. Please include your AMC serial number(s) on all correspondence.

Michael J. Werner
for

Rebecca Heick
Deputy State Director
Lands, Minerals and Energy Division

Enclosure

SENDER: COMPLETE THIS SECTION

- Complete items 1, 2, and 3.
- Print your name and address on the reverse so that we can return the card to you.
- Attach this card to the back of the mailpiece, or on the front if space permits.

1. Article Addressed to:

NAU PROJECT, LLC
 807 W BUTTERFIELD RD
 CHINO VALLEY, AZ 86323-5622
 920/RE/AMC435950

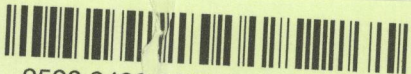

9590 9402 1279 5246 0923 00

2. Article Number (Transfer from service label)

7016 0340 0000 2483 9636

PS Form 3811, July 2015 PSN 7530-02-000-9053

COMPLETE THIS SECTION ON DELIVERY

A. Signature

X *Tracy Strickland*

- Agent
- Addressee

B. Received by (Printed Name)

C. Date of Delivery

5/31/14

D. Is delivery address different from item 1? Yes
If YES, enter delivery address below: No

RECEIVED
 BLANK STATE OFFICE
 JUN - 1 P 2:30
 PHOENIX, ARIZONA

3. Service Type

- Adult Signature
- Adult Signature Restricted Delivery
- Certified Mail®
- Certified Mail Restricted Delivery
- Collect on Delivery
- Collect on Delivery Restricted Delivery
- Insured Mail
- Registered Mail Restricted Delivery (\$500)

- Priority Mail Express®
- Registered Mail™
- Registered Mail Restricted Delivery
- Return Receipt for Merchandise
- Signature Confirmation™
- Signature Confirmation Restricted Delivery

Domestic Return Receipt

USPS TRACKING #

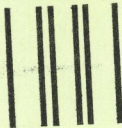

First-Class Mail
Postage & Fees Paid
USPS
Permit No. G-10

9590 9402 1279 5246 0923 00

United States
Postal Service

• Sender: Please print your name, address, and ZIP+4® in this box•

UNITED STATES
DEPARTMENT OF THE INTERIOR
Bureau of Land Management
Arizona State Office
One N. Central Avenue, Suite 800
Phoenix, AZ 85004-4427

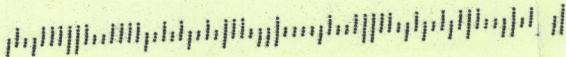



United States Department of the Interior

BUREAU OF LAND MANAGEMENT
Arizona State Office
One North Central Avenue, Suite 800
Phoenix, Arizona 85004-4427
www.blm.gov/az/



MAY 24 2016

In Reply Refer To:
3800 (9200) RE
AMC435950

CERTIFIED MAIL - RETURN RECEIPT REQUESTED No. 7016 0340 0000 2483 9636

NOTICE

NAU PROJECT, LLC	:	This Notice Affects the Claims
807 W BUTTERFIELD RD	:	Shown in the Block Below.
CHINO VALLEY, AZ 86323-5622	:	

AMC435950 - AMC435955
BRESCIA #3 - BRESCIA #6, TWIN EAGLE #3 - TWIN EAGLE #4

Mining Claim Location Notice(s) – Amendment(s) Required

Pursuant to Title 43 Code of Federal Regulations (CFR) 3832.1, the Bureau of Land Management (BLM), Arizona State Office, received your notices of location for recording mining claims. In accordance with 43 CFR 3832.12, the claims listed above cannot be accepted as filed and must be amended as noted below.

There is no metes and bounds description for the claim. A tie-in was provided from a section corner to a claim corner. However, the mining claim also needs to be described by metes and bounds from corner to corner.

In accordance with 43 CFR 3832.12 a lode claim must be described by metes and bounds and include a tie to a permanent monument such as a section quarter corner monument. All claim descriptions must include state, meridian, township, range, section and by aliquot part to the quarter section.

An amendment must be filed for each claim listed above to correct the defects identified. There is a \$10 BLM processing fee for each amendment. The amendments must be received by BLM within 30 days of your receipt of this notice. If the amendments are not received within the 30 day timeframe the mining claims will be declared null and void.

If additional information is required, please contact Rod Ebert at 602-417-9397. Please include your AMC serial number(s) on all correspondence.

A handwritten signature in black ink that reads "Rebecca Heick". The signature is written in a cursive style with a large initial 'R' and 'H'.

Rebecca Heick
Deputy State Director
Lands, Minerals and Energy Division

NOTICE!!

These documents have been scanned!

Do not place un-scanned documents beneath this notice!

Do not remove this notice from this file!

GPO Jacket No. 560-102
Print Order 61540
Rise Business Services, LLC
Job=AZ15 5/6/2019



Box Number= AZ15020



Claim Begin-End: AMC435950-AMC435955

3 Transfers



AZ15020-4

AMC435945-AMC436659

United States Department of the Interior
Bureau of Land Management
 DIV OF LANDS, MINRLS & ENERGY
 ONE N CENTRAL AVE
 PHOENIX, AZ 85004 -4427
 Phone: 602-417-9200

Receipt

No: 3597246

Transaction #: 3700554	
Date of Transaction: 07/01/2016	
CUSTOMER:	
NAU PROJECT LLC 807 BUTTERFIELD RD CHINO VALLEY, AZ 86323-5622 US	

LINE #	QTY	DESCRIPTION	REMARKS	UNIT PRICE	TOTAL
1	1.00	LOCATABLE MINERALS / MINING CLAIMS- NOT NEW-UNADJUD, ONE AUTH NO. ONLY / MINING CLAIM MONEY RECEIVED CASES: AMC435950/\$10.00	AMEND/1	- n/a -	10.00
TOTAL:					\$10.00

PAYMENT INFORMATION					
NOTE: Items will appear on credit card statement as "Bureau of Land Mgmt CO".					
1	AMOUNT:	10.00	POSTMARKED:	N/A	
	TYPE:	CREDIT CARD	RECEIVED:	07/01/2016	
	NAME:	NAU PROJECT LLC 807 BUTTERFIELD RD CHINO VALLEY AZ 86323-5622 US			
	CARD NO:	XXXXXXXXXXXX7075	AUTH CODE:	515656	
	NAME ON CARD:	NAU PROJECT LLC			
	EXPIRES:	09/2017			
	SIGNATURE:				

REMARKS

This receipt was generated by the automated BLM Collections and Billing System and is a paper representation of a portion of the official electronic record contained therein.

*Earned Amendment for:
AMC 435955*

RE 7/5/16



United States Department of the Interior

BUREAU OF LAND MANAGEMENT
Arizona State Office
One North Central Avenue, Suite 800
Phoenix, Arizona 85004-4427
www.blm.gov/az/



MAY 24 2016

JUNE 30

In Reply Refer To:
3800 (9200) RE
AMC435950

CERTIFIED MAIL - RETURN RECEIPT REQUESTED No. 7016 0340 0000 2483 9636

NOTICE

NAU PROJECT, LLC
807 W BUTTERFIELD RD
CHINO VALLEY, AZ 86323-5622

This Notice Affects the Claims
Shown in the Block Below.

RECEIVED
BLM AZ STATE OFFICE
2016 JUN 0 P 3:36
PHOENIX ARIZONA

AMC435950 - AMC435955
BRESCIA #3 - BRESCIA #6, TWIN EAGLE #3 - TWIN EAGLE #4

Mining Claim Location Notice(s) - Amendment(s) Required

Pursuant to Title 43 Code of Federal Regulations (CFR) 3832.1, the Bureau of Land Management (BLM), Arizona State Office, received your notices of location for recording mining claims. In accordance with 43 CFR 3832.12, the claims listed above cannot be accepted as filed and must be amended as noted below.

There is no metes and bounds description for the claim. A tie-in was provided from a section corner to a claim corner. However, the mining claim also needs to be described by metes and bounds from corner to corner.

In accordance with 43 CFR 3832.12 a lode claim must be described by metes and bounds and include a tie to a permanent monument such as a section quarter corner monument. All claim descriptions must include state, meridian, township, range, section and by aliquot part to the quarter section.

An amendment must be filed for each claim listed above to correct the defects identified. There is a \$10 BLM processing fee for each amendment. The amendments must be received by BLM within 30 days of your receipt of this notice. If the amendments are not received within the 30 day timeframe the mining claims will be declared null and void.

**United States Department of the Interior
Bureau of Land Management
DIV OF LANDS, MINRLS & ENERGY
ONE N CENTRAL AVE
PHOENIX, AZ 85004 -4427
Phone: 602-417-9200**

Receipt

No: 3597239

Transaction #: 3700548	
Date of Transaction: 07/01/2016	
CUSTOMER:	
NAU PROJECT LLC 807 BUTTERFIELD RD CHINO VALLEY, AZ 86323-5622 US	

LINE #	QTY	DESCRIPTION	REMARKS	UNIT PRICE	TOTAL
1	1.00	LOCATABLE MINERALS / MINING CLAIMS-NOT NEW-UNADJUD, ONE AUTH NO. ONLY / MINING CLAIM MONEY RECEIVED CASES: AMC435950/\$30.00	AMEND/3	- n/a -	30.00
TOTAL:					\$30.00

PAYMENT INFORMATION			
NOTE: Items will appear on credit card statement as "Bureau of Land Mgmt CO".			
1	AMOUNT:	30.00	POSTMARKED: N/A
	TYPE:	CREDIT CARD	RECEIVED: 07/01/2016
	NAME:	NAU PROJECT LLC 807 BUTTERFIELD RD CHINO VALLEY AZ 86323-5622 US	
	CARD NO:	XXXXXXXXXXXX7075	AUTH CODE: 148055
	NAME ON CARD:	NAU PROJECT LLC	
	EXPIRES:	09/2017	
	SIGNATURE:		

REMARKS

This receipt was generated by the automated BLM Collections and Billing System and is a paper representation of a portion of the official electronic record contained therein.

RE
An amendment was filed for
Amc 435955 - However, the money (\$\$)
to cover the amendment was not
included. Therefore, amendment ~~was~~ for

Earned Amendments for:
AMC 435950
AMC 435953
AMC 435954

NOTICE!!

These documents have been scanned!

Do not place un-scanned documents beneath this notice!

Do not remove this notice from this file!

GPO Jacket No. 560-102
Print Order 61540
Rise Business Services, LLC
Job=AZ15 5/6/2019



Box Number= AZ15020



Claim Begin-End: AMC435950-AMC435955

4 Annual Filings



AZ15020-4

AMC435945-AMC436659

DEPARTMENT OF THE INTERIOR
BUREAU OF LAND MANAGEMENT
MINING CLAIMS

Run Date/Time: 9/11/2018

MC Maintenance Fees Paid Through the BLM Pay Portal
(by Date Paid)

Page 598 Of 723

CBS Receipt: 4250909

Printed For Lead File # AMC435950

Agency Tracking ID: 1535682670

Assessment Year: 2019

Paid On: 8/31/2018

Number of BLM Serial Nr: 4

Total Amount Paid: \$620.00

Claim Name	BLM Serial No	Lead File No	Amount Paid
BRECCIA #3	AMC435950	AMC435950	\$155.00
BRECCIA #6	AMC435953	AMC435950	\$155.00
TWIN EAGLE #3	AMC435954	AMC435950	\$155.00
TWIN EAGLE #4	AMC435955	AMC435950	\$155.00

United States Department of the Interior

Bureau of Land Management

Receipt

BUSINESS & SUPPORT SVCS DIV

ONE N CENTRAL AVE SUITE 800

PHOENIX, AZ 85004 -4427

Phone: 602-417-9200

No:

4250909

Transaction #: 4366417	
Date of Transaction: 08/30/2018	
CUSTOMER:	
GREGORY YOUNT 807 W. BUTTERFIELD RD CHINO VALLEY,AZ 86323 US	

LINE #	QTY	DESCRIPTION	REMARKS	UNIT PRICE	TOTAL
1	1.00	LOCATABLE MINERALS / MINING CLAIMS- NOT NEW-UNADJUD,ONE AUTH NO. ONLY / MINING CLAIM MONEY RECEIVED CASES: AMC435950/\$620.00		- n/a -	620.00
TOTAL:					\$620.00

PAYMENT INFORMATION			
NOTE: Items will appear on credit card statement as "BLM O Mining Claim".			
1	AMOUNT:	620.00	POSTMARKED: N/A
	TYPE:	CREDIT CARD	RECEIVED: 08/30/2018
	NAME:	GREGORY YOUNT 807 W. BUTTERFIELD RD CHINO VALLEY AZ 86323 US	
	CARD NO:	XXXXXXXXXXXX1925	AUTH CODE: 03088C
	NAME ON CARD:	GREGORY YOUNT	
	SIGNATURE:		

REMARKS

This receipt was generated by the automated BLM Collections and Billing System and is a paper representation of a portion of the official electronic record contained therein.

Run Date: 09/05/17

Run Time: 02:33 PM

**DEPARTMENT OF THE INTERIOR
BUREAU OF LAND MANAGEMENT
MINING CLAIMS**

MC Maintenance Fees Paid Through the BLM Pay Portal

CBS Receipt: 3965295

Printed For Lead File # AMC435950

Agency Tracking ID: 1504026220

Assessment Year: 2018

Number of BLM Serial Nr: 4

Paid On: 08/29/2017

Total Amount Paid: \$620.00

Claim Name	BLM Serial No	Lead File No	Amount Paid
BRECCIA #3	AMC435950	AMC435950	\$155.00
BRECCIA #6	AMC435953	AMC435950	\$155.00
TWIN EAGLE #3	AMC435954	AMC435950	\$155.00
TWIN EAGLE #4	AMC435955	AMC435950	\$155.00

United States Department of the Interior
Bureau of Land Management
 BUSINESS & SUPPORT SVCS DIV
 ONE N CENTRAL AVE SUITE 800
 PHOENIX, AZ 85004 -4427
 Phone: 602-417-9200

Receipt

No: 3965295

Transaction #: 4075171	
Date of Transaction: 08/29/2017	
CUSTOMER:	
GREGORY YOUNT 807 W. BUTTERFIELD RD CHINO VALLEY, AZ 86323 US	

LINE #	QTY	DESCRIPTION	REMARKS	UNIT PRICE	TOTAL
1	1.00	LOCATABLE MINERALS / MINING CLAIMS- NOT NEW-UNADJUD, ONE AUTH NO. ONLY / MINING CLAIM MONEY RECEIVED CASES: AMC435955/\$620.00		- n/a -	620.00
TOTAL:					\$620.00

PAYMENT INFORMATION			
NOTE: Items will appear on credit card statement as "BLM O Mining Claim".			
1	AMOUNT:	620.00	POSTMARKED: N/A
	TYPE:	CREDIT CARD	RECEIVED: 08/29/2017
	NAME:	GREGORY YOUNT 807 W. BUTTERFIELD RD CHINO VALLEY AZ 86323 US	
	CARD NO:	XXXXXXXXXXXX1925	AUTH CODE: 02952C
	NAME ON CARD:	GREGORY YOUNT	
	EXPIRES:	11/2018	
	SIGNATURE:		

REMARKS

This receipt was generated by the automated BLM Collections and Billing System and is a paper representation of a portion of the official electronic record contained therein.

Run Date: 09/14/16

Run Time: 01:48 PM

**DEPARTMENT OF THE INTERIOR
BUREAU OF LAND MANAGEMENT
MINING CLAIMS**

MC Maintenance Fees Paid Through the BLM Pay Portal

CBS Receipt: 3649156

Printed For Lead File # **AMC435950**

Agency Tracking ID: 1472663265

Number of BLM Serial Nr: 4

Assessment Year: 2017

Paid On: 08/31/2016

Total Amount Paid: \$620.00

Claim Name	BLM Serial No	Lead File No	Amount Paid
BRECCIA #3	AMC435950	AMC435950	\$155.00
BRECCIA #6	AMC435953	AMC435950	\$155.00
TWIN EAGLE #3	AMC435954	AMC435950	\$155.00
TWIN EAGLE #4	AMC435955	AMC435950	\$155.00

United States Department of the Interior
Bureau of Land Management
 BUSINESS & SUPPORT SVCS DIV
 ONE N CENTRAL AVE SUITE 800
 PHOENIX, AZ 85004 -4427
 Phone: (602) 417-9200

Receipt

No: 3649156

Transaction #: 3753158	
Date of Transaction: 08/31/2016	
CUSTOMER:	
GREGORY YOUNT 807 W. BUTTERFIELD RD CHINO VALLEY, AZ 86323 US	

LINE #	QTY	DESCRIPTION	REMARKS	UNIT PRICE	TOTAL
1	1.00	LOCATABLE MINERALS / MINING CLAIMS- NOT NEW-UNADJUD, ONE AUTH NO. ONLY / MINING CLAIM MONEY RECEIVED CASES: AMC435955/\$620.00		- n/a -	620.00
TOTAL:					\$620.00

PAYMENT INFORMATION					
NOTE: Items will appear on credit card statement as "BLM O Mining Claim".					
1	AMOUNT:	620.00	POSTMARKED:	N/A	
	TYPE:	CREDIT CARD	RECEIVED:	08/31/2016	
	NAME:	GREGORY YOUNT 807 W. BUTTERFIELD RD CHINO VALLEY AZ 86323 US			
	CARD NO:	XXXXXXXXXXXX1925	AUTH CODE:	03144C	
	NAME ON CARD:	GREGORY YOUNT			
	EXPIRES:	11/2018			
	SIGNATURE:				

REMARKS

This receipt was generated by the automated BLM Collections and Billing System and is a paper representation of a portion of the official electronic record contained therein.

Mining Claim Status Report

Data Entered: 15 JAN 16

MTP Checked By: _____

GEO Checked By: [Signature]

LEAD SERIAL NUMBER: AMC 435950 thru AMC 435955

NUMBER OF CLAIMS & TYPE:

6 LODE
 _____ PLACER
 _____ ASSOCIATION PLACER
 _____ MILL SITE
 _____ TUNNEL SITE

CHARGES:

Location Fee @ \$37 = \$ 222
 Processing Fee @ \$20 = \$ 120
 Maintenance Fee @ \$155 = \$ 930
 Add'l Maint Fee for Assoc Placer = \$ _____
SUBTOTAL \$ _____
 Other Fees \$ _____
 Other Fees \$ _____
TOTAL \$ 1,272

TOTAL ACREAGE: _____ Per Claim
(Placer Only)

NUMBER OF LOCATORS: _____

DOCUMENTS RECEIVED VIA: Over-the-Counter [] Mail [] TIMELY FILED: Yes [] No []

LEGAL DESCRIPTION: T 12.5N R 3W SEC 25, 26, 36
 T _____ R _____ SEC _____
 T _____ R _____ SEC _____
 T _____ R _____ SEC _____
 T _____ R _____ SEC _____

BLM [] FOREST SERVICE [] _____ SUBJ TO PL 359: Yes [] No []
WILDERNESS AREA [] _____

SPLIT ESTATE: N/A [] SX [] PX [] OTHER [] _____
SRHA [] Was proper Notice filed if located on SHRA Land? Yes [] No []

RECONVEYED MINERALS ON BLM LAND REQUIRE OPENING ORDER FROM 1944 TO 1993:

Open to Entry On _____ N/A []

COMMENTS/STATUS: VOID [] PARTIALLY VOID [] PVT MINERALS [] WITHDRAWN LANDS []
OTHER [] _____

Will send a Notice to supply m²b from corner to corner
Maps for claims (esp AMC 435954-955) leave something to be desired for
noting boundaries of section, quarter section but was able to determine
the location

[] Claimant acknowledges that portions of the following claim(s) site(s) may be void or voidable.

Printed Name of Claimant _____ Signature of Claimant _____

*****FINAL ADJUDICATION*****

DATE 5-5-16 INITIALS RS

AMC435950

Return To: Gregory Yount
807 W. BUTTERFIELD RD.
CHINO VALLEY, AZ 86301



AMENDED

LOCATION NOTICE FOR LODE MINING CLAIM

NOTICE IS HEREBY GIVEN that the Breccia #3
_____ lode mining claim has been located
by NAU Project, LLC whose current mailing
address is 807 W. Butterfield Rd Chino Vally, Az 86323

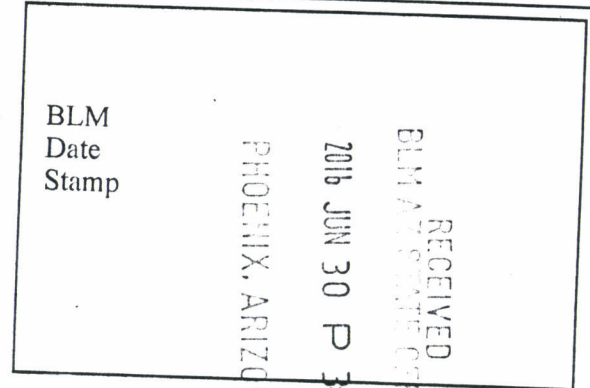

The general course of this claim is WNW to ESE and it is situated in Yavapai
County, Arizona. This claim is 1500 feet in length and 600 feet in width. This claim runs
from the location monument on which this location notice is posted approximately 686 feet in a ESE
East direction to the East end line and 814 feet in a WNW direction to the
West end line. This claim is marked by six monuments, one at each corner and one at the center of each
end line of the claim.

The location monument on which this notice is posted is situated within Section 26, Township 12 1/2 N
3, Range 3 West, Gila Salt River Base and Meridian, Arizona and this claim encompasses portions
of the following quarter section (s), section (s), Townships (s) and Range (s) SE Quarter of Section 26 of
Township 12 1/2 North and Range 3W.

Gila Salt River Base and Meridian, Arizona.

To tie this claim to the Public Survey, begin at the NE corner of Section 26 Township 12 1/2 N
Range 3W of the G&SR Base and Meridian. Bear 3500 feet South, and 990 feet West
to the NE corner of this claim.

PRIOR RECORDING NO. 2015-0060710

DATED AND POSTED on the ground this 9th day of November, 20 15

LOCATORS (s) [Signature] MANAGER THE NAU PROJECT, LLC
GREGORY YOUNT

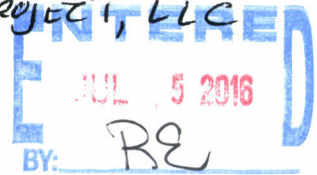

AMC 435950

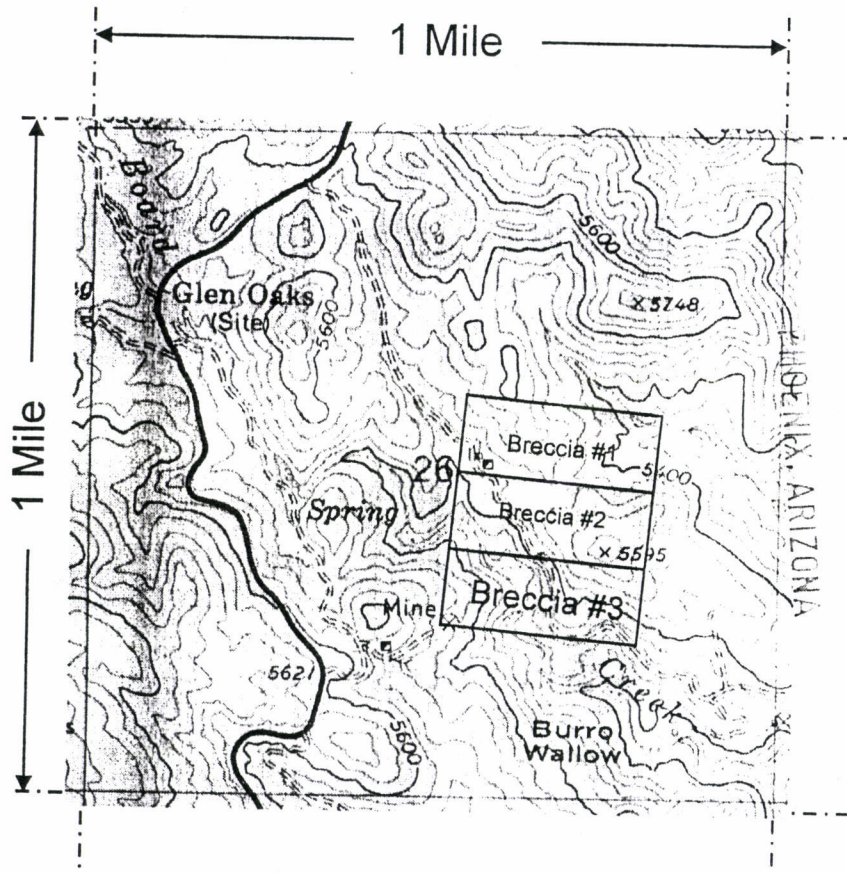

Scale : 1" = 2000 feet

1. The above map depicts the Breccia #3 mining claim, which is located in Section (s) 26, Township 12 ½ N, Range 3 West, Gila and Salt River Base and Meridian, Yavapai County, Arizona.
2. The type of corner and location monuments used are as follows: Location Monument: 2X2 post
Corner monuments: Wood
3. The bearings and distances in degrees and feet between claim corners are as depicted on the map and described below.
4. The bearings and distances between the corners of the claim are beginning at the NW corner of the claim 1500 feet in a ^{E7°S}ESE direction to the NE corner, then 600 feet in a ^{S7°W}SSW direction to the SE corner, then 1500 feet in a ^{W7°N}WNW direction to the SW corner, and then 600 feet in a ^{N7°E}NNE direction, to the point of beginning.

AMENDED

Return To: Gregory Yount
807 W. BUTTERFIELD RD.
CHINO VALLEY, AZ 86301

2015-0060710 NML Page: 1 of 2
12/23/2015 03:13:50 PM
Leslie M. Hoffman
OFFICIAL RECORDS OF YAVAPAI COUNTY \$10.00
GREGORY YOUNT



LOCATION NOTICE FOR LODE MINING CLAIM

NOTICE IS HEREBY GIVEN that the Breccia #3
lode mining claim has been located
by NAU Project, LLC whose current mailing
address is 807 W. Butterfield Rd Chino Vally, Az 86323

RECEIVED
BLM ARIZONA OFFICE
2016 JAN 11 P 2:58
PHOENIX, ARIZONA
BLM
Date
Stamp

The general course of this claim is WNW to ESE and it is situated in Yavapai
County, Arizona. This claim is 1500 feet in length and 600 feet in width. This claim runs
from the location monument on which this location notice is posted approximately 686 feet in a ESE
direction to the East end line and 814 feet in a WNW direction to the
West end line. This claim is marked by six momuments, one at each corner and one at the center of each
end line of the claim.

The location monument on which this notice is posted is situated within Section 26, Township 12 1/2 N
Range 3 West, Gila Salt River Base and Meridian, Arizona and this claim encompasses portions
of the following quarter section (s), section (s), Townships (s) and Range (s) SE Quarter of Section 26 of
Township 12 1/2 North and Range 3W.

Gila Salt River Base and Meridian, Arizona.

To tie this claim to the Public Survey, begin at the NE corner of Section 26 Township 12 1/2 N
Range 3W of the G&SR Base and Meridian. Bear 3500 feet South, and 990 feet West
to the NE corner of this claim.

DATED AND POSTED on the ground this 9th day of November, 2015

LOCATORS (s) *[Signature]* MANAGER, THE NAU PROJECT, LLC
GREGORY YOUNT

AMC435950

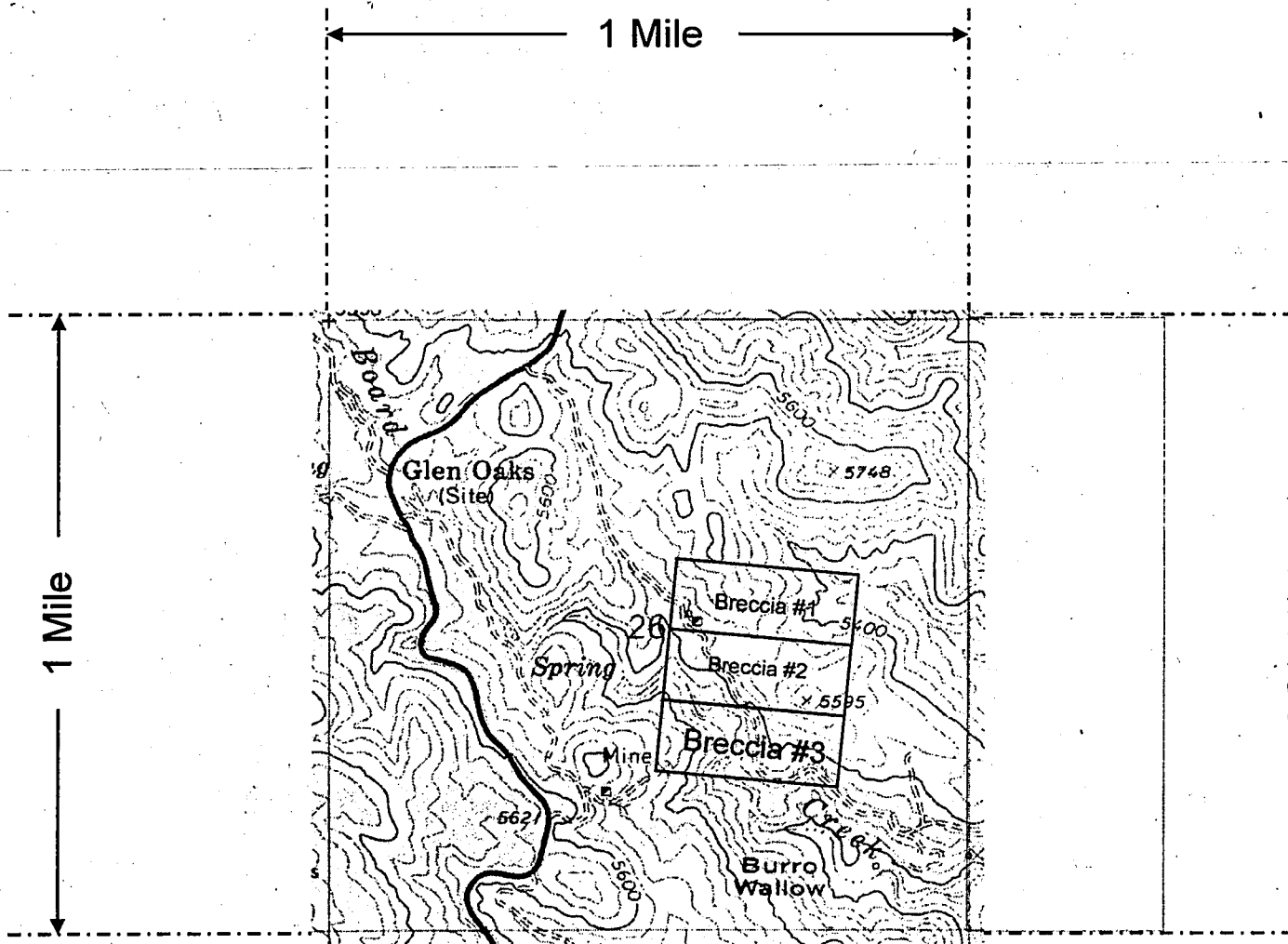

AHC435950

Scale : 1" = 2000 feet

RECEIVED
 BLM AZ STATE OFFICE
 2016 JAN 11 P 2:58
 PHOENIX, ARIZONA

1. The above map depicts the Breccia #3 mining claim, which is located in Section (s) 26, Township 12 1/2 N, Range 3 West, Gila and Salt River Base and Meridian, Yavapai County, Arizona.
2. The type of corner and location monuments used are as follows: Location Monument: 2X2 post
Corner monuments: Wood
3. The bearings and distances in degrees and feet between claim corners are as depicted on the map.

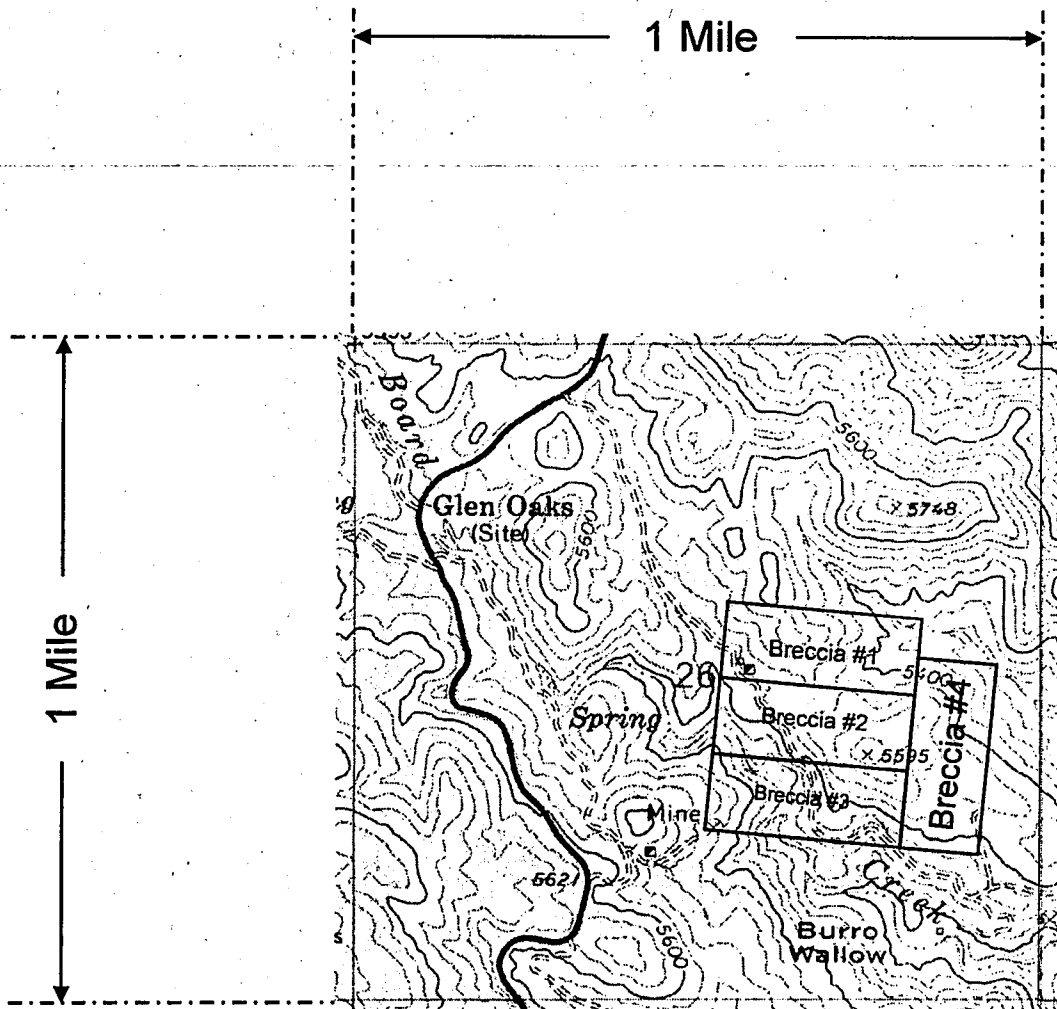

AHC 435951

RECEIVED
BLM AZ STATE OFFICE
2016 JAN 11 P 2:59
PHOENIX, ARIZONA

Scale : 1" = 2000 feet

1. The above map depicts the Breccia #4 mining claim, which is located in Section (s) 26, Township 12 1/2 N, Range 3 West, Gila and Salt River Base and Meridian, Yavapai County, Arizona.
2. The type of corner and location monuments used are as follows: Location Monument: 2X2 post
Corner monuments: Wood
3. The bearings and distances in degrees and feet between claim corners are as depicted on the map.

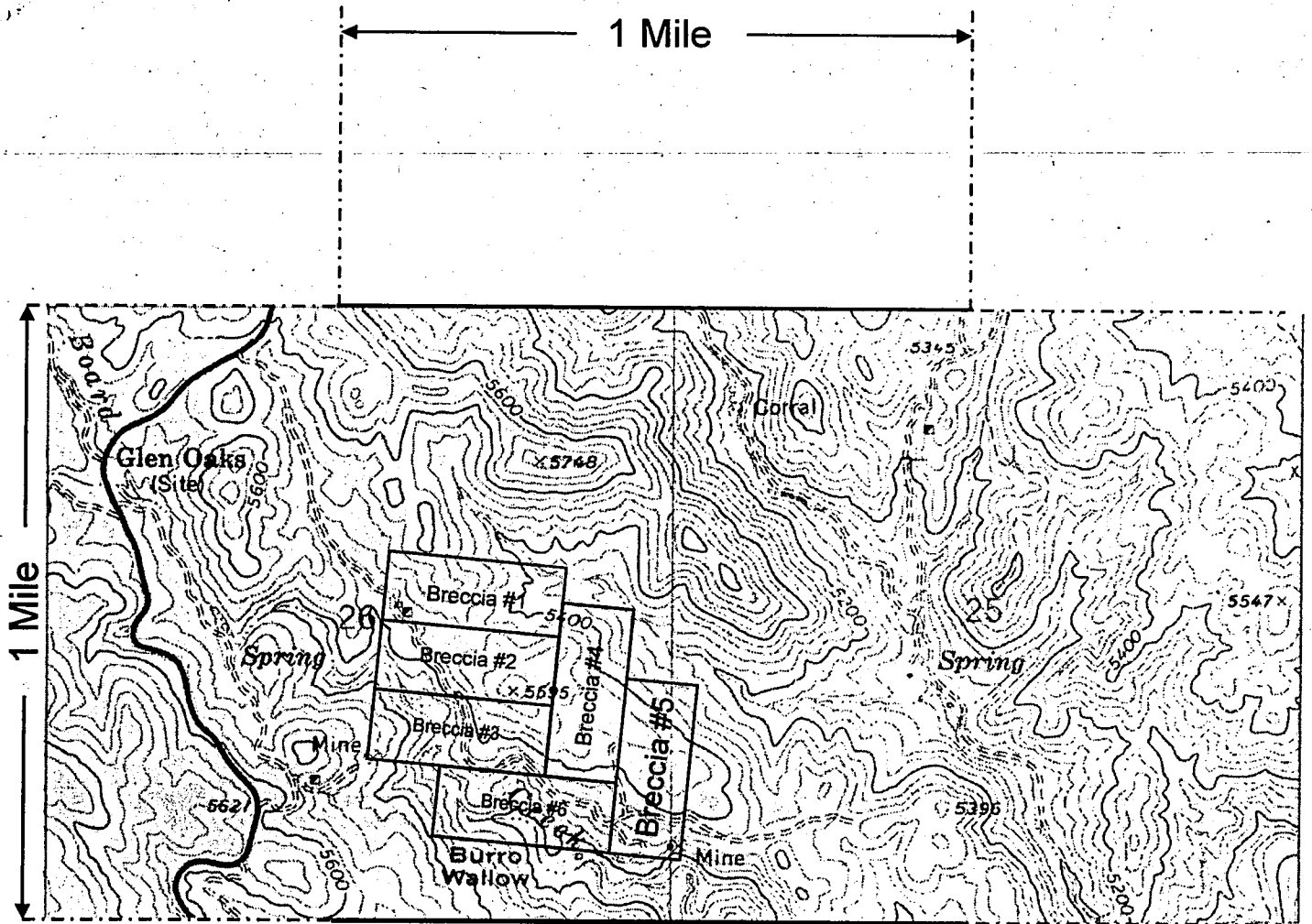

Scale : 1" = 2000 feet

RECEIVED
 BLM A7 STATE OFFICE
 2016 JAN 11 P 2:59
 PHOENIX, ARIZONA

1. The above map depicts the Breccia #5 mining claim, which is located in Section (s) 26, Township 12 1/2 N, Range 3 West, Gila and Salt River Base and Meridian, Yavapai County, Arizona.
2. The type of corner and location monuments used are as follows: Location Monument: 2X2 post
Corner monuments: Wood
3. The bearings and distances in degrees and feet between claim corners are as depicted on the map.

AHC435952

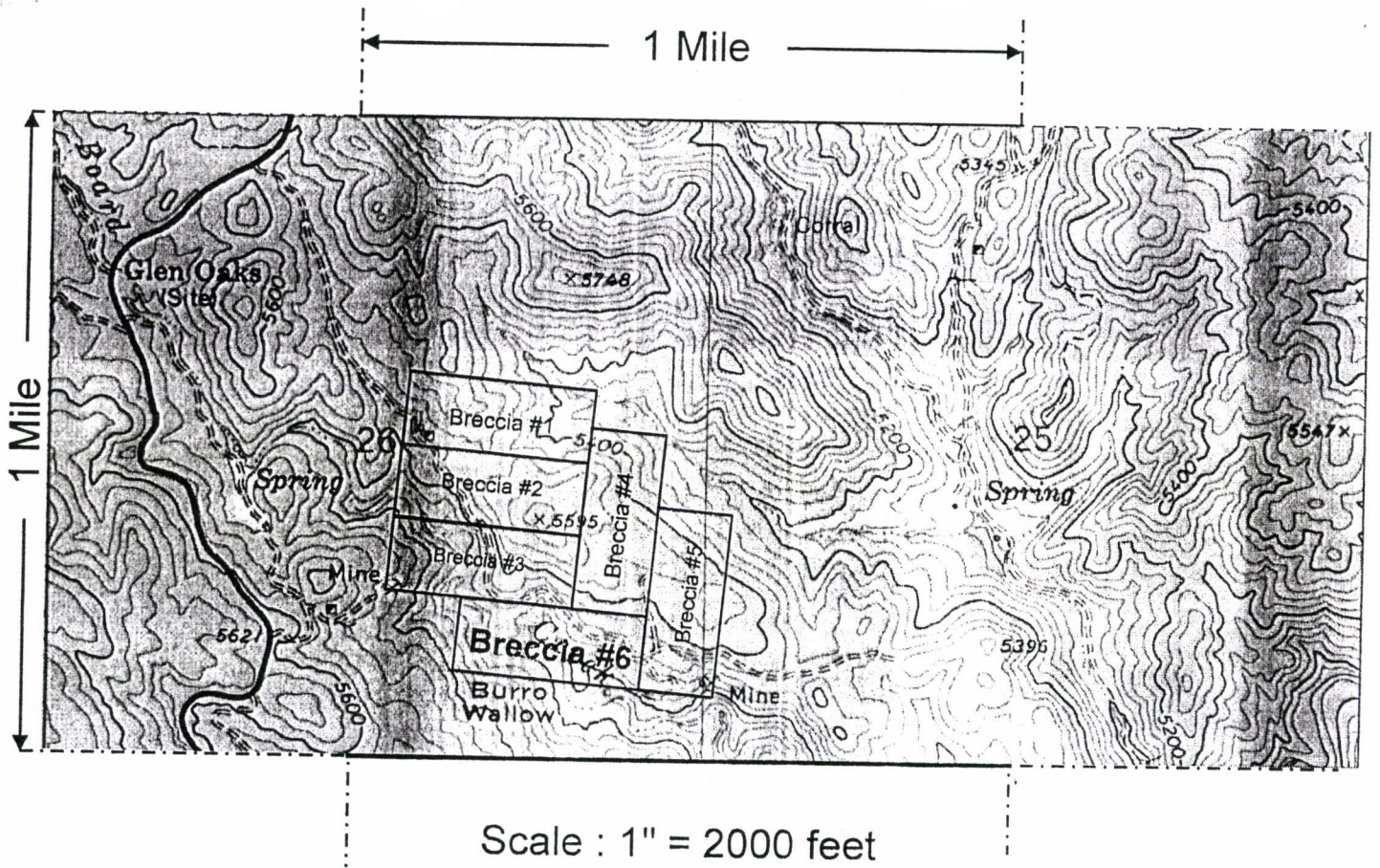

1. The above map depicts the Breccia #6 mining claim, which is located in Section (s) 26, Township 12 1/2 N, Range 3 West, Gila and Salt River Base and Meridian, Yavapai County, Arizona.
2. The type of corner and location monuments used are as follows: Location Monument: 2X2 post
Corner monuments: Wood
3. The bearings and distances in degrees and feet between claim corners are as depicted on the map and described below.
4. The bearings and distances between the corners of the claim are beginning at the NW corner of the claim 1500 feet in a ^{E7°S} ESE direction to the NE corner, then ^{S70°W} 600 feet in a SSW direction to the SE corner, then ^{W37°N} 1500 feet in a WNW direction to the SW corner, and then ^{N70°E} 800 feet in a NNE direction, to the point of beginning.

RECEIVED
 BLM STATE OFFICE
 PHOENIX, ARIZONA
 JUN 30 P 3:37

AMENDED

SR
Return To: Gregory Yount
807 W. BUTTERFIELD RD.
CHINO VALLEY, AZ 86301



LOCATION NOTICE FOR LODE MINING CLAIM

NOTICE IS HEREBY GIVEN that the Breccia #6
lode mining claim has been located
by NAU Project, LLC whose current mailing
address is 807 W. Butterfield Rd Chino Vally, Az 86323

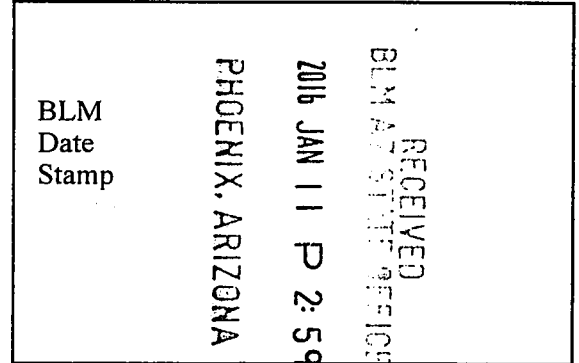



The general course of this claim is WNW to ESE and it is situated in Yavapai
County, Arizona. This claim is 1500 feet in length and 600 feet in width. This claim runs
from the location monument on which this location notice is posted approximately 40 feet in a ESE
direction to the East end line and 1460 feet in a WNW direction to the
West end line. This claim is marked by six monuments, one at each corner and one at the center of each
end line of the claim.

The location monument on which this notice is posted is situated within Section 26, Township 12 1/2 N
3, Range West, Gila Salt River Base and Meridian, Arizona and this claim encompasses portions
of the following quarter section (s), section (s), Townships (s) and Range (s) SE Quarter of Section 26 of
Township 12 1/2 North and Range 3W.

Gila Salt River Base and Meridian, Arizona.

To tie this claim to the Public Survey, begin at the NE corner of Section 26 Township 12 1/2 N
Range 3W of the G&SR Base and Meridian. Bear 4130 feet South, and 456 feet West
to the NE corner of this claim.

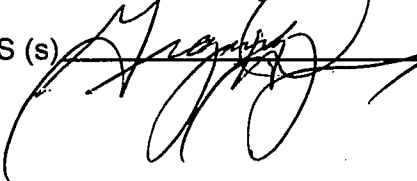
DATED AND POSTED on the ground this 9th day of November, 2015

LOCATORS (s)   MANABOR, THE NAU PROJECT LLC
GREGORY YOUNT

ANCI 35953

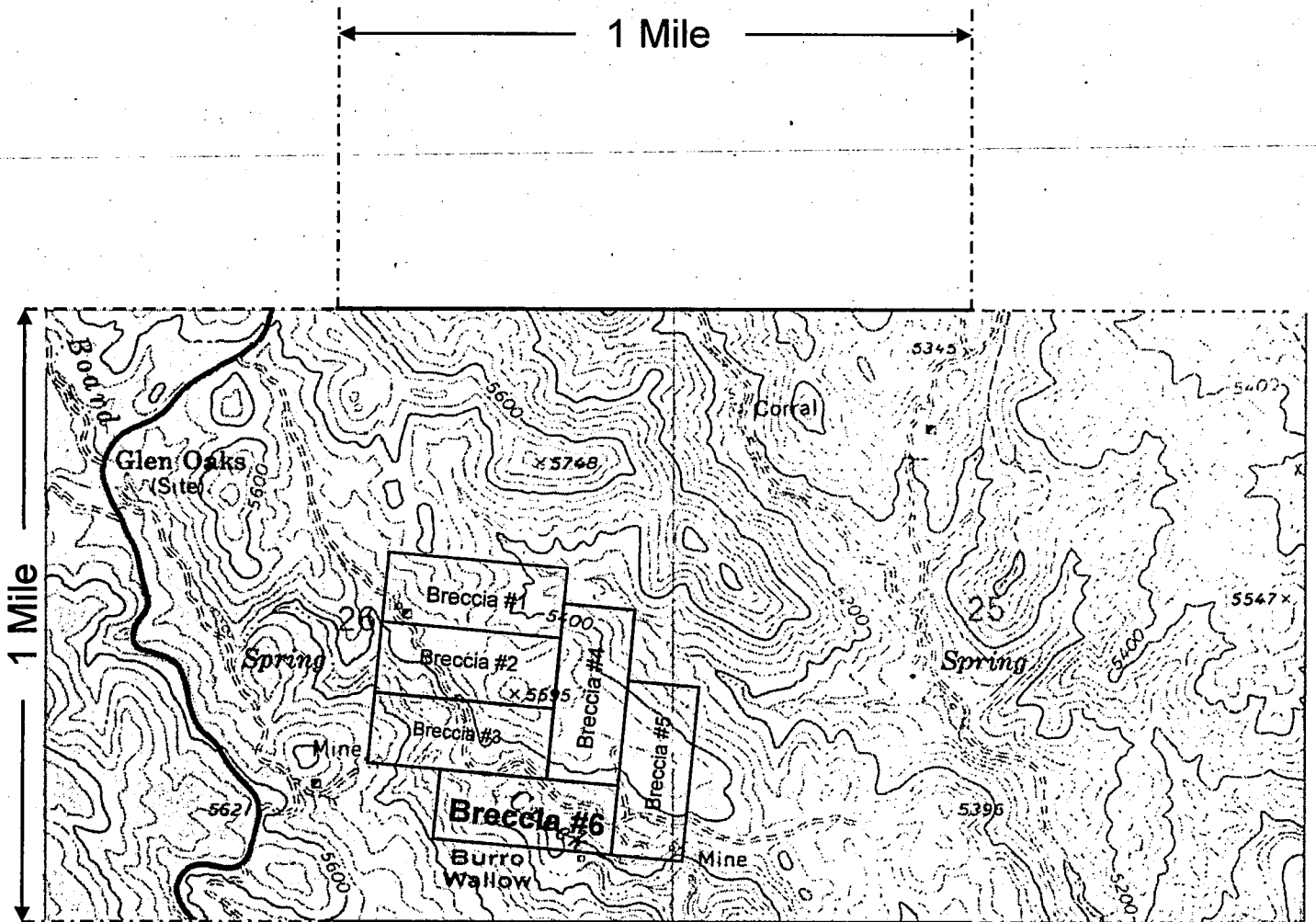

RECEIVED
 BLM AZ STATE OFFICE
 2016 JAN 11 P 2:59
 PUEBLO, ARIZONA

Scale : 1" = 2000 feet

AHC 15953

1. The above map depicts the Breccia #6 mining claim, which is located in Section 26, Township 12 1/2 N, Range 3 West, Gila and Salt River Base and Meridian, Yavapai County, Arizona.
2. The type of corner and location monuments used are as follows: Location Monument: 2X2 post
Corner monuments: Wood
3. The bearings and distances in degrees and feet between claim corners are as depicted on the map.

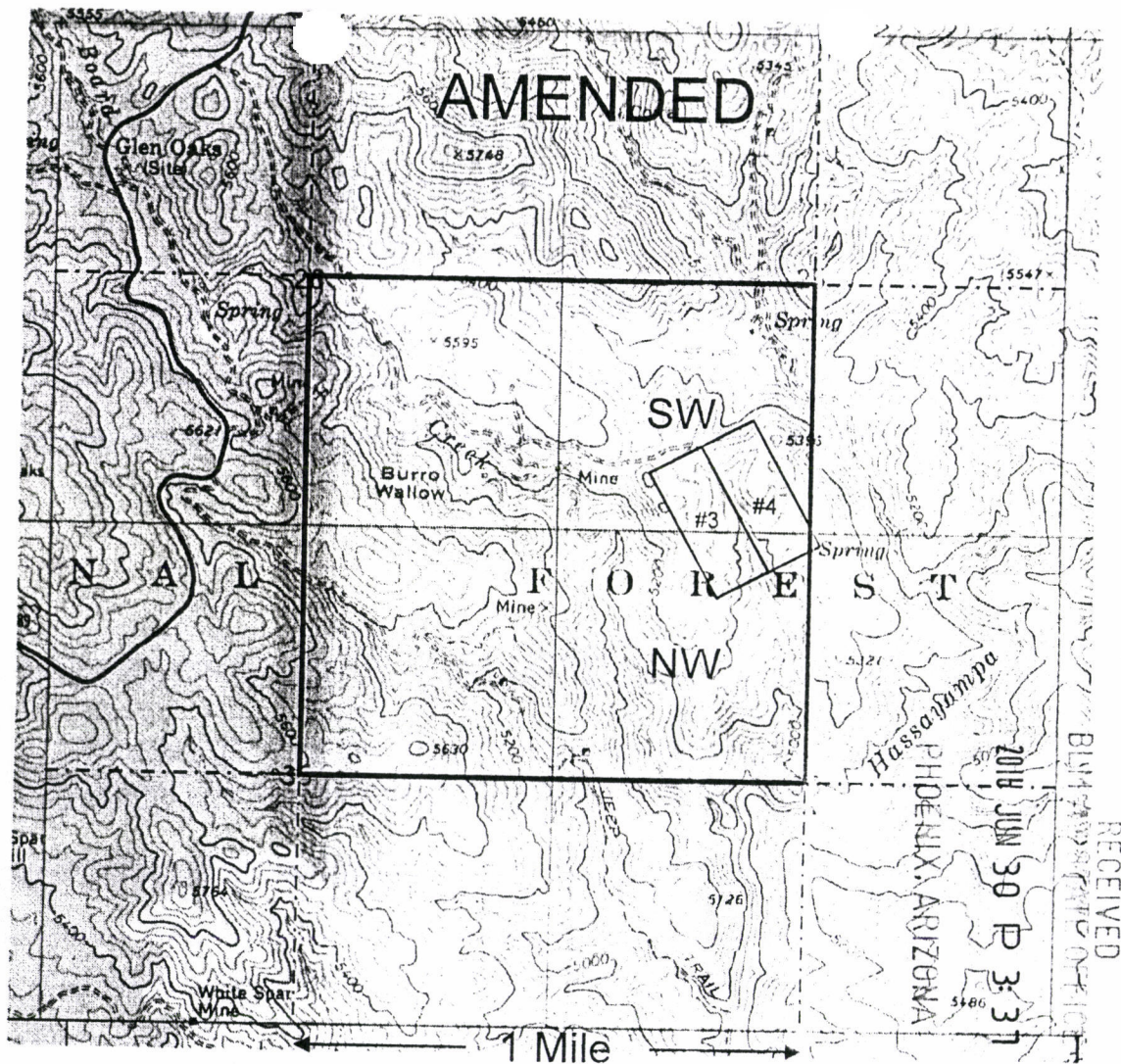

Scale : 1" = 2000 feet

1. The above map depicts the Twin Eagle #3 mining claim, which is located in Section (s) 25,36, Township 12 ½ N, Range 3 West, Gila and Salt River Base and Meridian, Yavapai County, Arizona.
2. The type of corner and location monuments used are as follows: Location Monument: Pipe
 Corner monuments: Pipe
3. The bearings and distances in degrees and feet between claim corners are as depicted on the map and described below.
4. The bearings and distances between the corners of the claim are beginning at the NW corner of the claim 600 feet in a ^{N62°E}ENE direction to the NE corner, then ^{S28°E}1500 feet in a SSE direction to the SE corner, then ^{W28°S}600 feet in a WSW direction to the SW corner, and then ^{N28°W}1500 feet in a NNW direction, to the point of beginning.

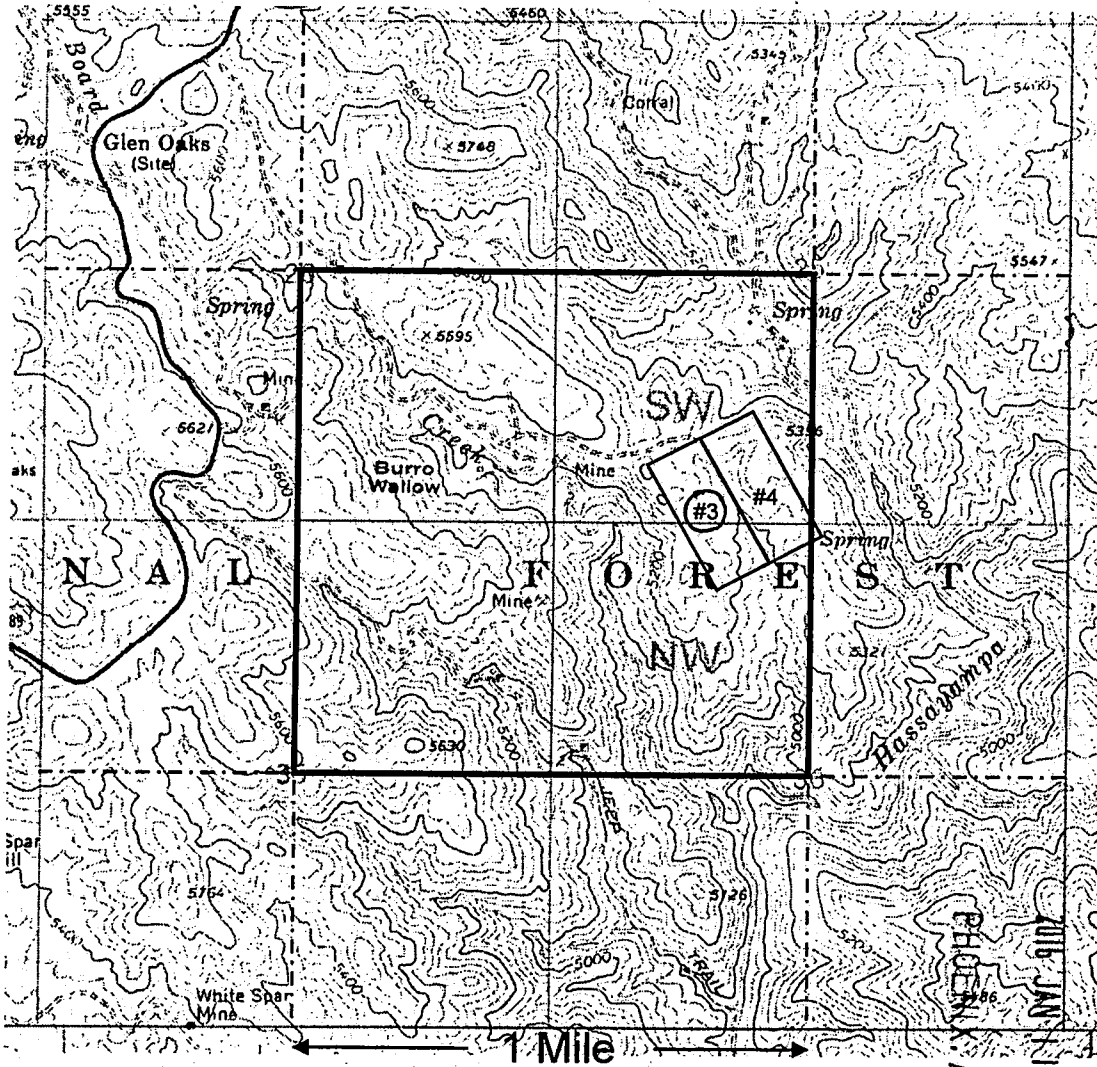

#

AHC435954

RECEIVED
 BLM AT STATE OFFICE
 JUL 6 JAN 11 P 2:58
 PHOENIX, ARIZONA

Scale : 1" = 2000 feet

1. The above map depicts the Twin Eagle #3 mining claim, which is located in Section (s) 25,36, Township 12 1/2 N, Range 3 West, Gila and Salt River Base and Meridian, Yavapai County, Arizona.
2. The type of corner and location monuments used are as follows: Location Monument: Pipe
Corner monuments: Pipe
3. The bearings and distances in degrees and feet between claim corners are as depicted on the map.

Return To: Gregory Yount
807 W. BUTTERFIELD RD.
CHINO VALLEY, AZ 86301

2016-0029831 ANML
06/22/2016 01:44:58 PM Page: 1 of 2
Leslie M. Hoffman
OFFICIAL RECORDS OF YAVAPAI COUNTY \$10.00
GREGORY YOUNT



AMENDED

LOCATION NOTICE FOR LODE MINING CLAIM

NOTICE IS HEREBY GIVEN that the Twin Eagle #4
_____ lode mining claim has been located
by NAU Project, LLC whose current mailing
address is 807 W. Butterfield Rd Chino Vally, Az 86323

RECEIVED
BLM AZ STATE OFFICE
2016 JUN 30 P 3:37
PHOENIX, ARIZONA
BLM
Date
Stamp

The general course of this claim is NW to SE and it is situated in Yavapai
County, Arizona. This claim is 1500 feet in length and 600 feet in width. This claim runs
from the location monument on which this location notice is posted approximately 700 feet in a NW
direction to the North end line and 800 feet in a SE direction to the
South end line. This claim is marked by six monuments, one at each corner and one at the center of each
end line of the claim.

The location monument on which this notice is posted is situated within Section 25, Township 12 1/2 N
3 West, Gila Salt River Base and Meridian, Arizona and this claim encompasses portions
of the following quarter section (s), section (s), Townships (s) and Range (s) SW Quarter of Section 25 and
the NW and NE Quarters of Section 36 of Township 12 1/2 North and Range 3W.

Gila Salt River Base and Meridian, Arizona.

To tie this claim to the Public Survey, begin at the SW corner of Section 25 Township 12 1/2 N
Range 3W of the G&SR Base and Meridian. Bear 902 feet North, and 1490 feet East
to the NW corner of this claim. **PRIOR RECORDING No. 2015-0660709**

DATED AND POSTED on the ground this 18 th day of December, 20 15

LOCATORS (s) _____

MANAGER, THE NAU PROJECT, LLC
GREGORY YOUNT

ENTERED
JUL 5 2016
BY: RE

AMC 435955

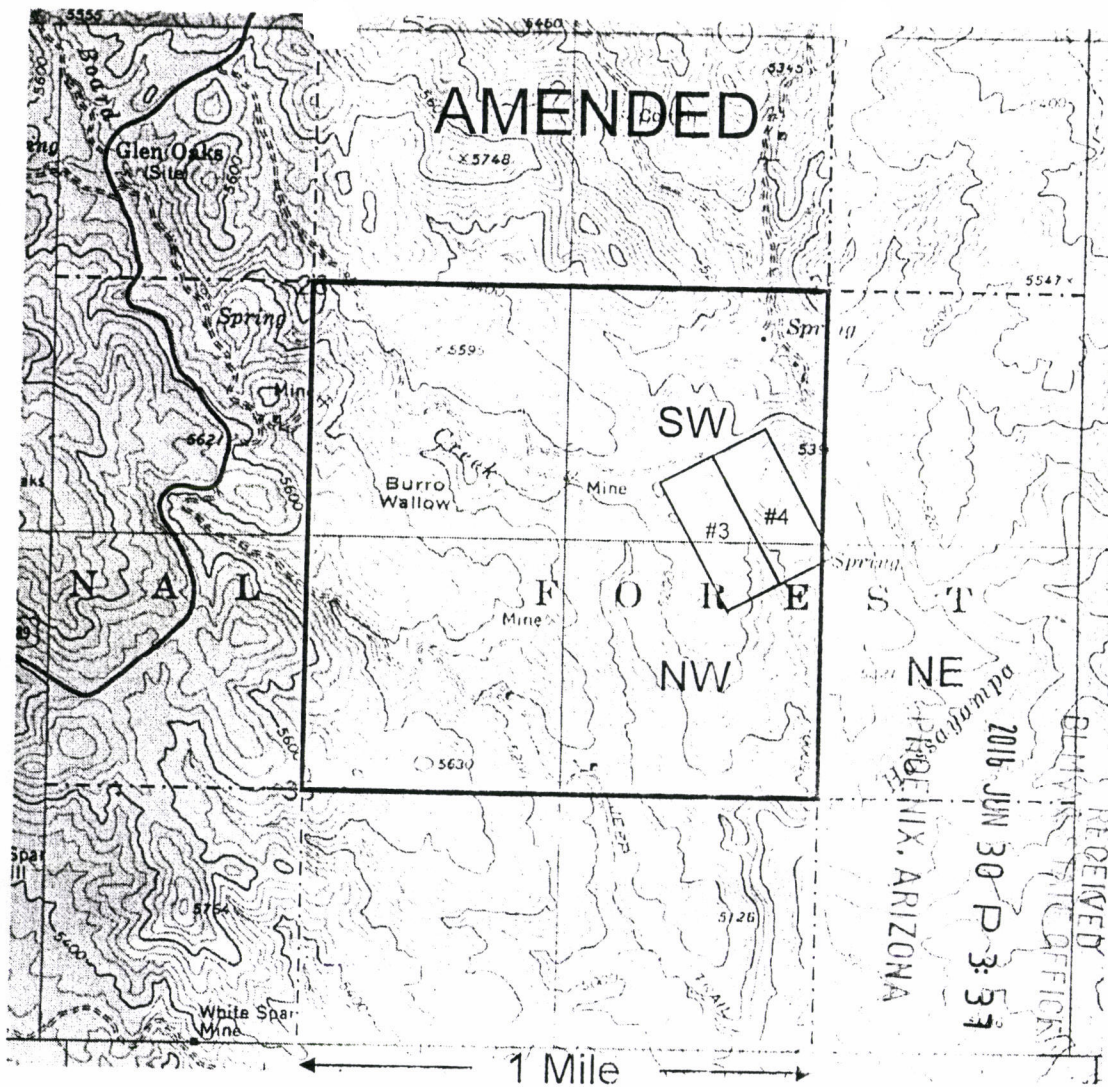

Scale : 1" = 2000 feet

1. The above map depicts the Twin Eagle #4 mining claim, which is located in Section (s) 25,36, Township 12 1/2 N, Range 3 West, Gila and Salt River Base and Meridian, Yavapai County, Arizona.
2. The type of corner and location monuments used are as follows: Location Monument: Pipe
Corner monuments: Pipe
3. The bearings and distances in degrees and feet between claim corners are as depicted on the map and described below.
4. The bearings and distances between the corners of the claim are beginning at the NW corner of the claim 600 feet in a ^{N62°E} ENE direction to the NE corner, then 1500 feet in a ^{S28°E} SSE direction to the SE corner, then 600 feet in a ^{W28°S} WSW direction to the SW corner, and then 1500 feet in a ^{N28°W} NNW direction, to the point of beginning.

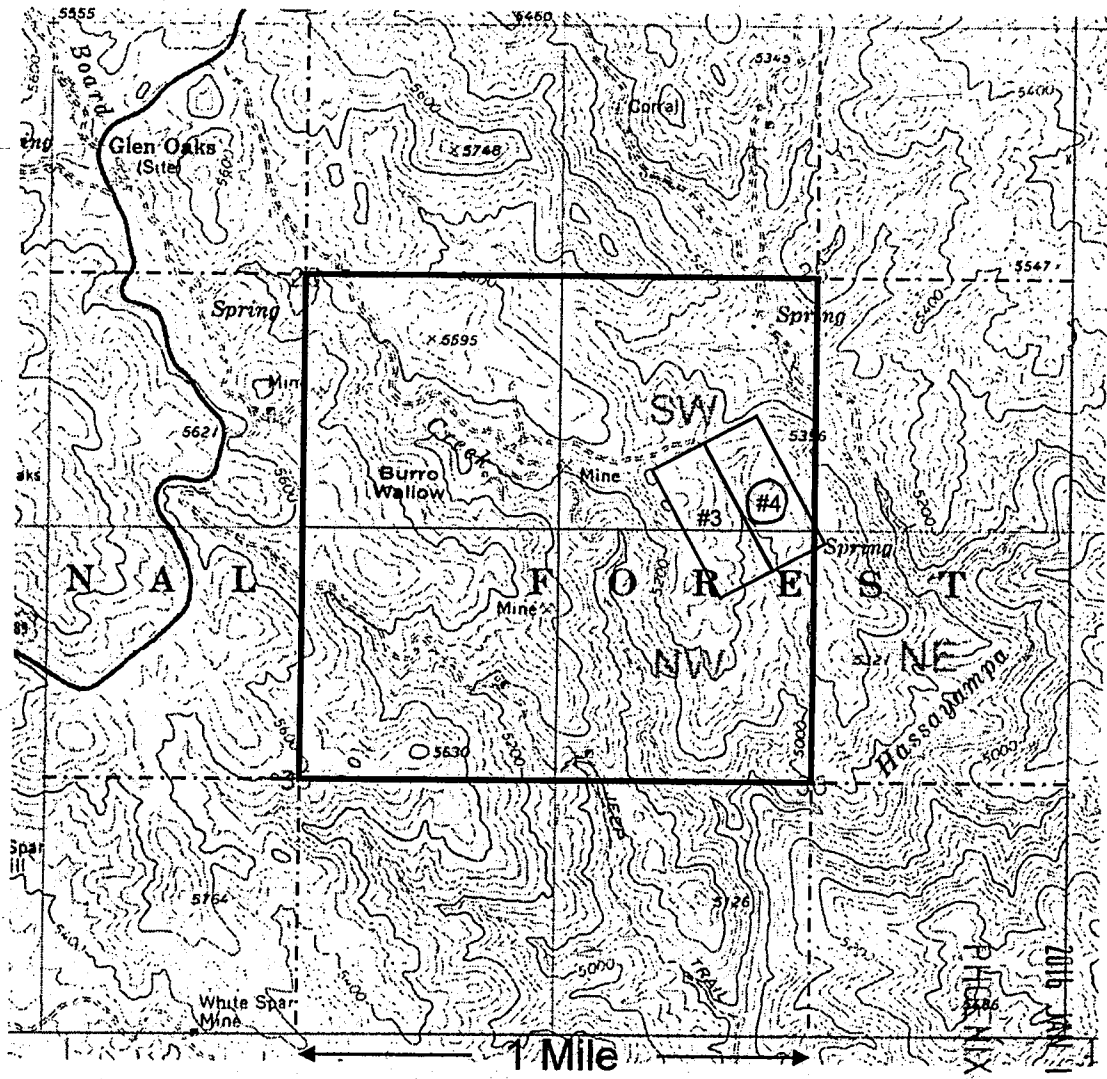

AH0435955

RECEIVED
BLM & STATE OFFICE
PHOENIX, ARIZONA
JAN 11 P 2:58

Scale : 1" = 2000 feet

1. The above map depicts the Twin Eagle #4 mining claim, which is located in Section (s) 25,36, Township 12 1/2 N, Range 3 West, Gila and Salt River Base and Meridian, Yavapai County, Arizona.
2. The type of corner and location monuments used are as follows: Location Monument: Pipe
Corner monuments: Pipe
3. The bearings and distances in degrees and feet between claim corners are as depicted on the map.

DEPARTMENT OF INTERIOR
BUREAU OF LAND MANAGEMENT

Input Parameters for Geographic Report with Land

System Id = CR

Admin State = AZ

Geo State =

Casetype Begins With

Case Disp Txt = AUTHORIZED, CANCELLED, EXPIRED, PENDING, REJECTED, RELINQUISHED, WITHDRAWN

Mer Twp Rng =

Section =

Mtrs = 14 0122N 0030W 025, 14 0122N 0030W 026, 14 0122N 0030W 036, 14 0122N 0030W 999

Commodity =

Commodity Txt =

Pending Org =

Pend Org Decode =

Total Rows Returned: 1

RUN TIME: 01:48 PM

UNITED STATES DEPARTMENT OF INTERIOR
BUREAU OF LAND MANAGEMENT
GEOGRAPHIC REPORT WITH LAND
Sorted by Serial Number

RUN DATE: 01/15/2016
Page 1 of 1

Serial Number: AZA 013951
Total Case Acres: 327.000

<u>Casetype</u>	<u>Case Disp</u>				<u>Sect</u>	<u>Sur Typ</u>	<u>Sur Num</u>	<u>Suff</u>	<u>Subdivision</u>	<u>Act Pend</u>
282107	AUTHORIZED	14	0122N	0030W	026	ALIQ			ALL;	

TOWNSHIP 12½ NORTH RANGE 3 WEST OF THE GILA AND SALT RIVER MERIDIAN, ARIZONA

STATUS OF PUBLIC DOMAIN
LAND AND MINERAL TITLES

**MTP
SUPPL Sec 25,33,36**

INDEX TO SEGREGATED TRACTS			
RESURVEY	ORIGINAL SURVEY		
TRACT NO	T	R	SUBDIVISION

FOR ORDERS EFFECTING DISPOSAL OR USE OF
UNIDENTIFIED LANDS WITHDRAWN FOR CLASSIFICATION,
MINERALS, WATER AND/OR OTHER PUBLIC PURPOSES,
REFER TO INDEX OF MISCELLANEOUS DOCUMENTS.

DIST. NO. 2

ARO4756-B Rev April

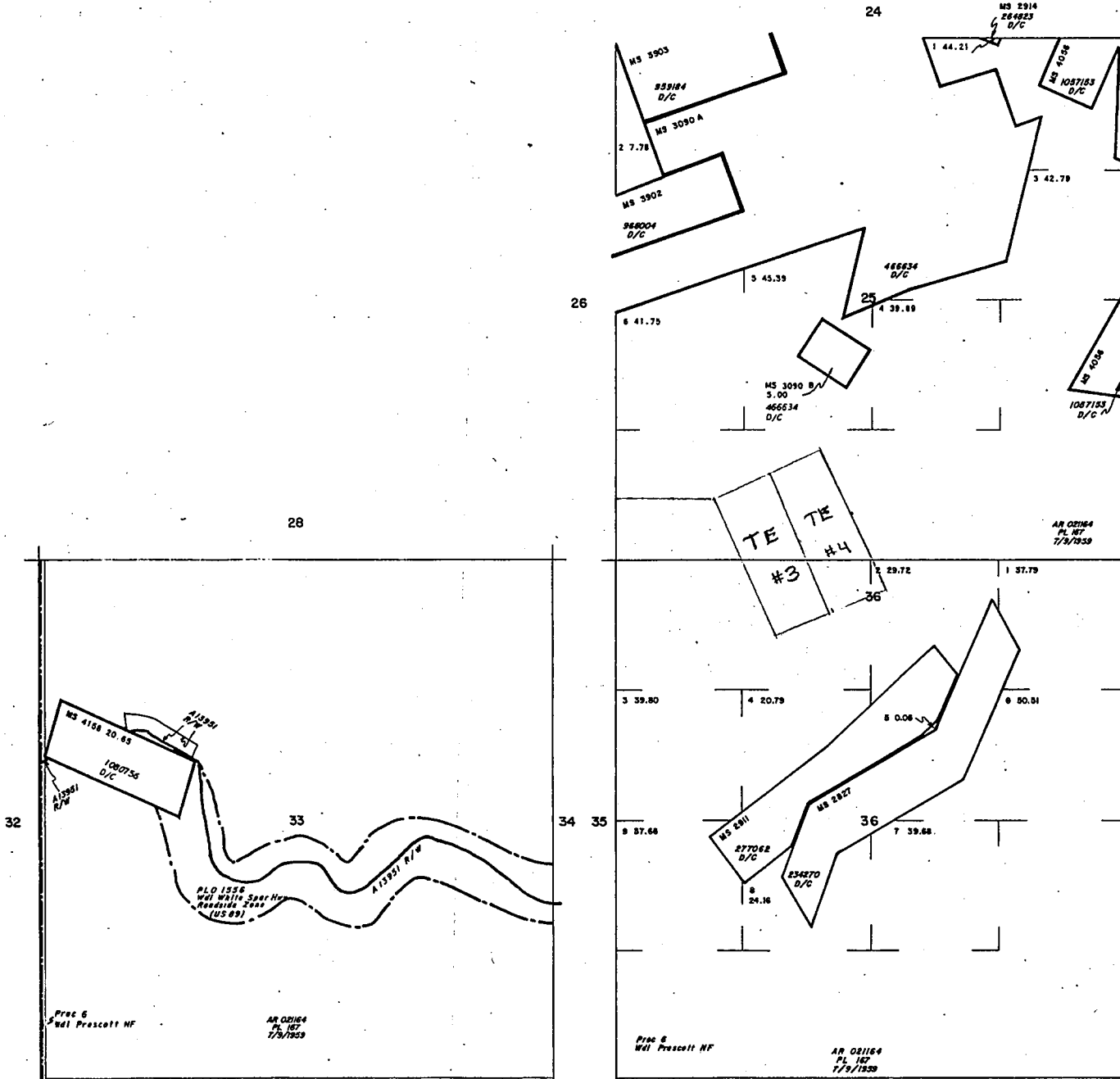

SCALE
0 5 10 20
10 chains to the inch

WARNING STATEMENT
This plat is the Bureau's Record of Title, and should be used only as a graphic display of the available survey data. Sections herein do not reflect title changes which may have been effected by lateral movements of rivers or other bodies of water. Refer to the colonial surveys for official survey information.

CURRENT TO	BY

T. J. W. R. J. W.

$$170 \overline{) 1500} \begin{array}{r} 8 \\ 1360 \\ \hline 140 \end{array}$$

$$170 \overline{) 3500} \begin{array}{r} 2 \\ 340 \\ \hline 100 \end{array}$$

$$32.5 \overline{) 52800} \begin{array}{r} 169 \\ 325 \\ \hline 2030 \\ 1625 \\ \hline 3050 \\ 2924 \\ \hline 1260 \end{array}$$

$$179 \overline{) 1200} \begin{array}{r} 6 \\ 1074 \\ \hline 126 \end{array}$$

$$179 \overline{) 1500} \begin{array}{r} 8 \\ 1432 \\ \hline 68 \end{array}$$

$$179 \overline{) 5280} \begin{array}{r} 29 \\ 3580 \\ \hline 1700 \end{array}$$

NOTICE!!

These documents have been scanned!

Do not place un-scanned documents beneath this notice!

Do not remove this notice from this file!

GPO Jacket No. 560-102
Print Order 61540
Rise Business Services, LLC
Job=AZ15 5/6/2019



Box Number= AZ15020



Claim Begin-End: AMC435950-AMC435955

5 Miscellaneous



AZ15020-4

AMC435945-AMC436659

**NO
DOCUMENTS
FOUND**

NO DOCUMENTS FOUND
NO DOCUMENTS FOUND

NOTICE!!

These documents have been scanned!

Do not place un-scanned documents beneath this notice!

Do not remove this notice from this file!

GPO Jacket No. 560-102
Print Order 61540
Rise Business Services, LLC
Job=AZ15 5/6/2019



Box Number= AZ15020



Claim Begin-End: AMC435950-AMC435955

6 Location Notices-Amendments and Supporting Documents



AZ15020-4

AMC435945-AMC436659

**NO
DOCUMENTS
FOUND**

NO DOCUMENTS FOUND
NO DOCUMENTS FOUND